

TUG TECHNOLOGIES

Providing Ground Support Solutions Worldwide



Model shown above includes additional options.

TUG Model MA Ramp Tractor

The MA is a time-tested, field proven tow tractor with 3,000 to 6,000 pounds (1,362 to 2,722 kg) drawbar pull to handle all of your cargo and baggage towing requirements and to provide pushback for private and regional aircraft with a MTOW up to 60,000 pounds (27,220 kg). An enclosed cabin and other options are available. Other features include solid-state ignition, engine emission control, automatic transmission and disc brakes on the rear wheels operated via a dual caliper system. Simple, rugged and easy access to all components assure long life on even the most demanding ramps.

Equipment Sales
Tel: (770) 422-7230
Fax: (770) 428-7315

Parts Sales
Tel: (800) 989-8499
Fax: (770) 422-8730

Online
www.tugtech.com

Standard features include:

- Recessed headlights
- Combination tail and stop lights
- Power boosted disc brake system
- Automatic transmission
- Seat belts
- Non-slip surface on floor boards
- Non-slip surface on brake pedal
- Engine speed governor
- Adjustable over center park brake lever
- Split braking systems
- Front, rear & side reflectors



If it doesn't say TUG, it's not TUG TUFF

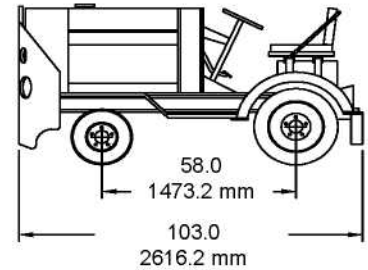
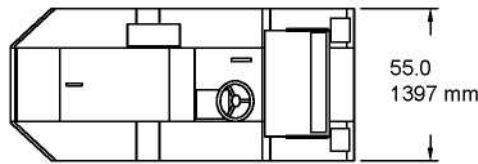
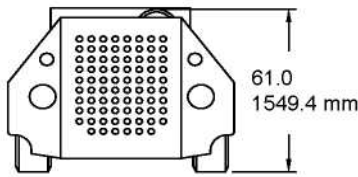

Specifications

Model MA

Tow Tractor

Dimensions

Length excluding coupler..... 103" (2616.2 mm)
 Width..... 55.0" (1397.0 mm)
 Height less cab 61" (1549.4 mm)
 Height with cab 82.5" (2095.5 mm)
 Wheelbase 59" (1498.6 mm)
 Minimum ground clearance 6.5" (165.1 mm)
 Steer axle under clearance 7.8" (198.12 mm)
 Frame under clearance 10" (254.0 mm)
 Turning radius 115" (2921.0 mm)
 Maximum governed speed..... 15 mph (24.14 kph)

Drawbar Pull by Model

Model	Drawbar Pull	GVW
MA30	3000 lb (1362 kg)	3750lb (1701 kg)
MA40	4000lb (1816 kg)	5000lb (2268 kg)
MA50	5000 lb (2268 kg)	6250lb (2835 kg)
MA60	6000 lb (2722 kg)	7500lb (3402 kg)

Engine Options

Ford DSG-423 EFI Gasoline

Type..... Water-cooled, EFI, 4
 Cylinder
 Fuel Gas
 Displacement 140 CID (2.3L)
 Governed rpm with full load 2600
 Net brake hp at governed rpm..... 79 (59 kW)
 Torque at 3200 rpm..... 130 lb ft (174 Nm)

Perkins 1104C-44 Diesel

Type Water-cooled, direct injected,
 in-line, 4 cylinder
 Fuel Diesel or Jet A (with additive)
 Displacement..... 269 CID (4.4 L)
 Governed rpm with full load 2400
 Net brake hp at governed rpm 86 (64kW)
 Torque at 1400 rpm..... 222 lb ft (302 Nm)

Deutz D2011L04 Diesel

Type..... Oil-cooled, direct injected
 in-line, 4 cylinder
 Fuel Diesel or Jet A
 Displacement..... 189 CID (3.1 L)
 Governed rpm with full load 2500
 Net brake hp at governed rpm 49 (36.5 kW)
 Torque at 1700 rpm..... 140 lb ft (190 Nm)

Transmission

Type..... Ford industrial 3-speed automatic
 transmission w/torque converter

Drive Axle

Type..... Heavy-duty 6,000 lb
 capacity axle with drop box

Drive Shaft

Type .Double universal, sliding spline coupling

Electrical System

Type..... 12 V, negative ground
 Alternator 91 A

Cooling System

Engine 15 qt (14.2 L)
 Heavy-duty radiator and fan
 Transmission Radiator cooled

Fuel System

Fuel Cell Capacity 15.5 U.S. gal (58.67 L)
 Fuel options Gasoline, diesel or LP

Brakes System

Service Dual split system, vacuum boosted
 with four calipers on the rear axle
 and 13-inch cast iron rotors
 Parking Lever operated, drum type

Steering System

Type..... Ball and screw gearbox, heavy-duty
 front steer axle with inclined king
 pins, bushings and bearings

Suspension

Front Leaf springs
 Rear..... Rubber mount

Tires (MA30-50)

Front 6.9 x 9, 6-ply rating
 Rear..... 8 x 16.5, 8-ply rating

Tires (MA60)

Front 6.5 x 10 TT, 6-ply rating
 Rear..... 9.5 x 16.5, 8-ply rating

Hitch

Standard "E" hitch Other options available

Instruments

Diesel Powered

Water temperature, Oil pressure, Ammeter, Hour meter

Gasoline Powered

Hour meter

Engine Performance Module (EPM) Indicator light

Partial List of Options

Cab
 Overhead guard
 Fuel gauge on instrument panel
 Backup alarm
 Snow plow
 Charlyn hydraulic steering
 Additional hitches to fit customer specifications
 Others available upon request



Equipment Sales

815 Allgood Road • Marietta, GA 30062 USA

Tel: (770) 422-7230 • Fax (770) 428-7315

www.tugtech.com

TUG OEM Parts

TUG Parts: (800) 989-8499 * (770) 422-8021

Fax: (770) 422-8730

www.tugparts.com

